



For Sublease

711-713 Troy Schenectady Road

Latham, NY 12110

Space Overview

- 54,170 SF in total
 - 37,860 SF on the 3rd floor and the 711 building including an existing data center and mail room;
 - 1,426 SF of storage space on the 1st floor of in the 711 building;
 - 14,884 SF on the 3rd floor in the 713 building.
- Sublease term is through 1/31/2027
- Space includes a data center, mail room, and print facility.
- Furniture can be included

Asking Rent:

\$15.00/SF

Space:

54,170 SF

Contact



Todd Stevens

518.424.7717 mobile
tstevens@cresa.com



Zac Conley

518.859.2990 mobile
zconley@cresa.com

Even though obtained from sources deemed reliable, no warranty or representation, express or implied, is made as to the accuracy of the information herein, and it is subject to errors, omissions, change of price, rental or other conditions, withdrawal without notice, and to any special listing conditions imposed by our principals.

cresa

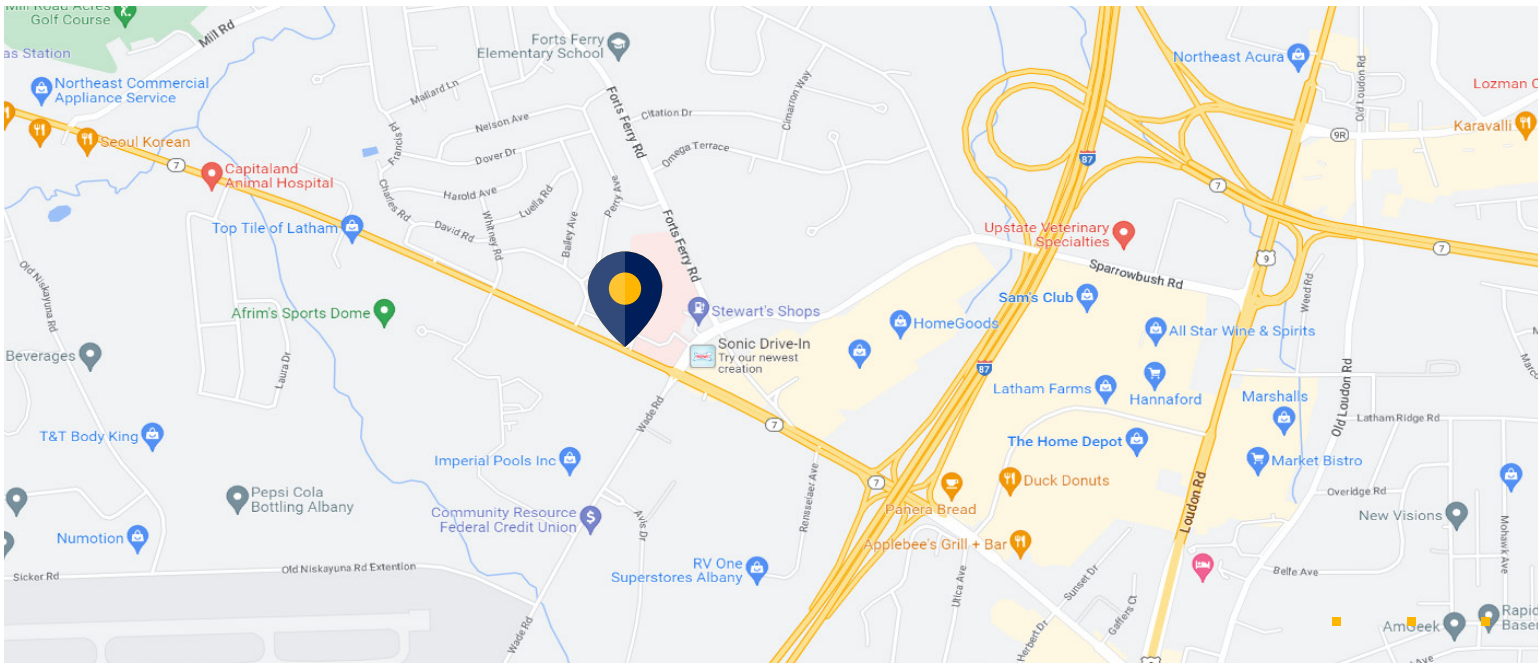

Floorplan - 711 Building, Third Floor

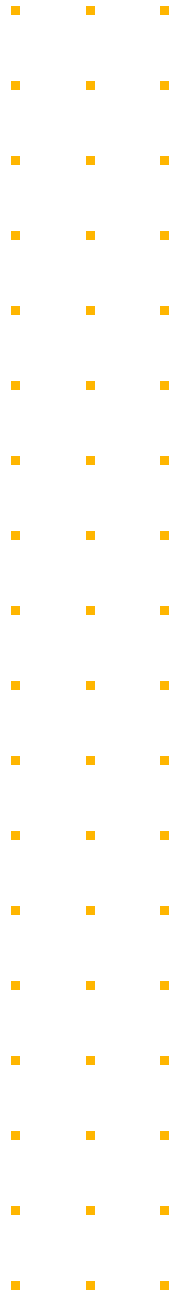
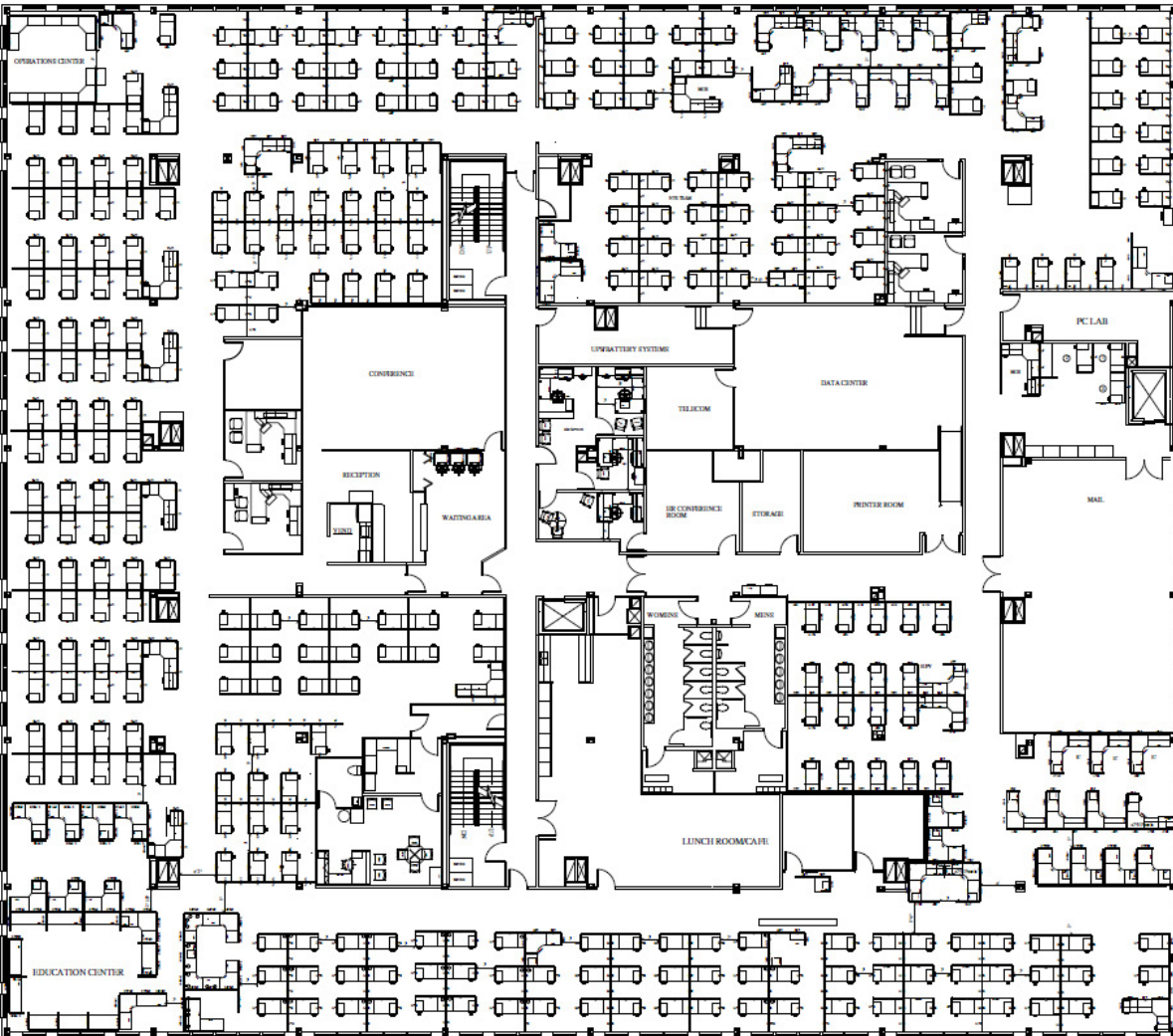

Floorplan - 713 Building, Third Floor



For Sublease

711-713

Troy Schenectady Road, Latham NY 12110





For Sublease
711-713
Troy Schenectady Road, Latham NY 12110





For Sublease
711-713
Troy Schenectady Road, Latham NY 12110

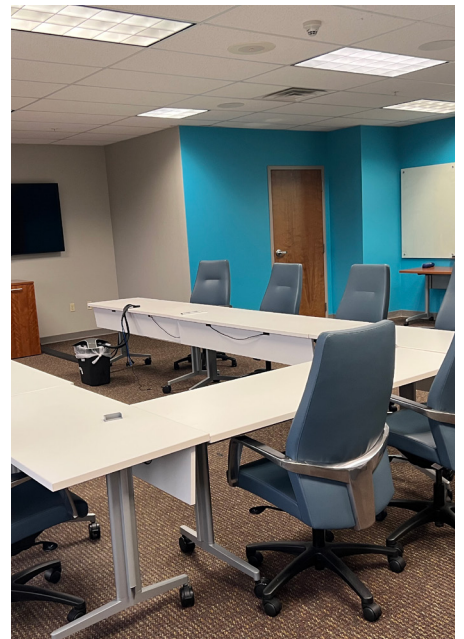



Beyond space.

Contact

For more information, please contact:

Todd Stevens

518.424.7717 mobile
518.380.5002 direct
tstevens@cresa.com

Zac Conley

518.859.2990 mobile
518.380.5006 direct
zconley@cresa.com

cresa.com/albany-ny

Even though obtained from sources deemed reliable, no warranty or representation, express or implied, is made as to the accuracy of the information herein, and it is subject to errors, omissions, change of price, rental or other conditions, withdrawal without notice, and to any special listing conditions imposed by our principals.

