

SUBLEASE 2803 Manor Rd.

±3,850 - 11,389 SF



Contact

Logan Dagleish
ldagleish@cresa.com
913.707.9194

Scott Studzinski
sstudzinski@cresa.com
512.983.7916

cresa 

PROPERTY INFORMATION

SUBLEASE

**THE STATION
2803 MANOR RD.
AUSTIN, TX 78722**

Rate: \$41.00/SF NNN

Opex: \$14.60/PSF

Shared Space Size: 3,850 SF

Full Sublease Size: 11,389 SF

Available: October 1, 2023



- 18 Existing Sit/ Stand Desks
- Break Area w/ Kitchen
- Parking at 3/1000 SF
- Break Area w/ Kitchen
- Wellness/ Mother's Room
- Large Windows, Natural Light
- Furnished Conference Rooms
- Mobile Door Access
- Flexible Term
- Creative Co-Working Atmosphere



FLOORPLAN

± 3,850 SF

2803 MANOR RD.

*Proposed Shared Space Highlighted Below

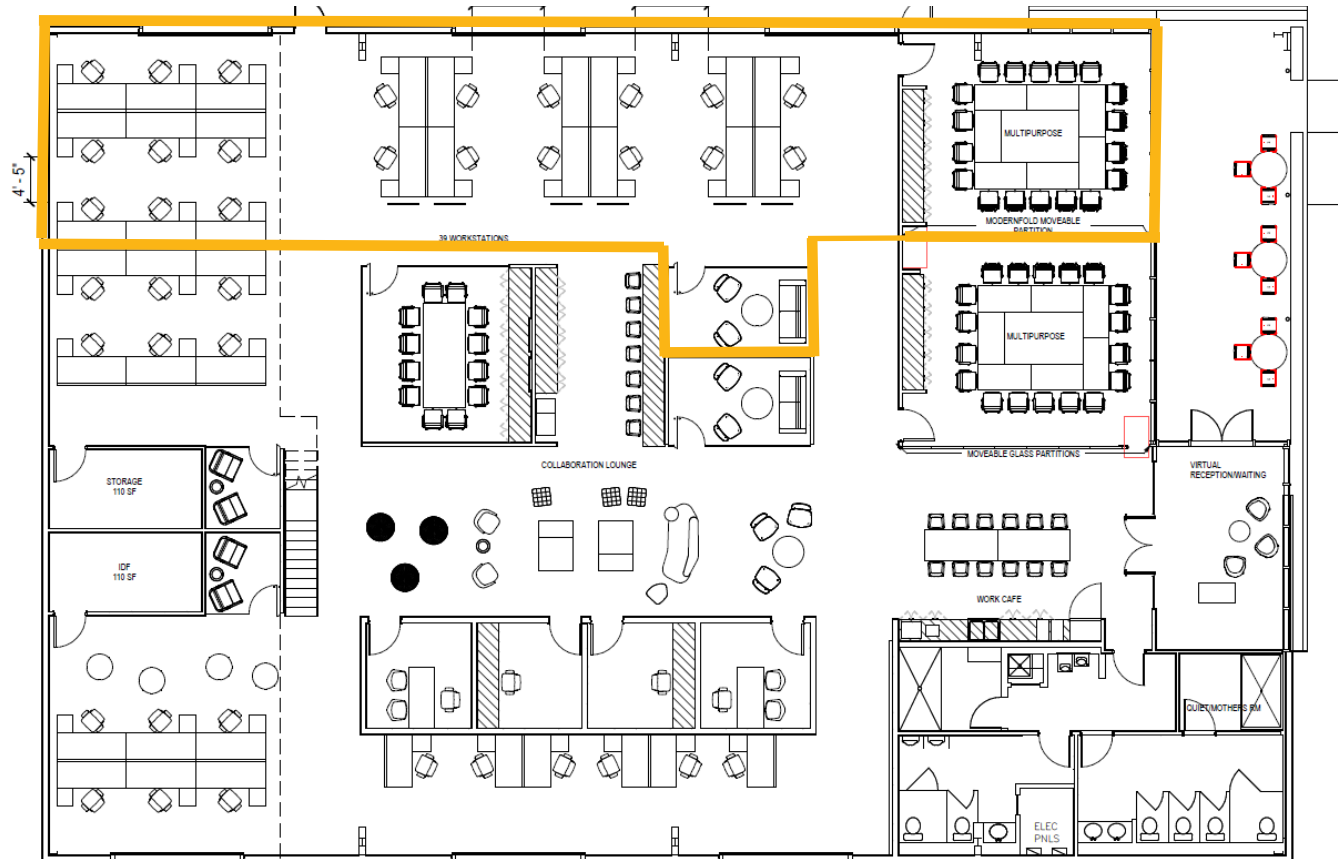

First Floor

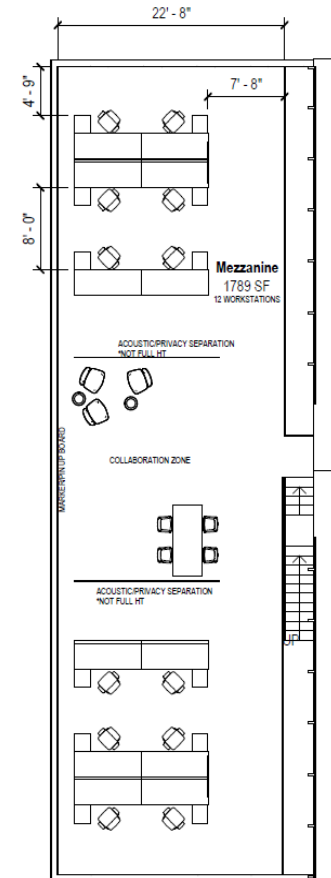

Mezzanine

FLOORPLAN

± 11,389 SF

*Full Sublease Space

2803 MANOR RD.

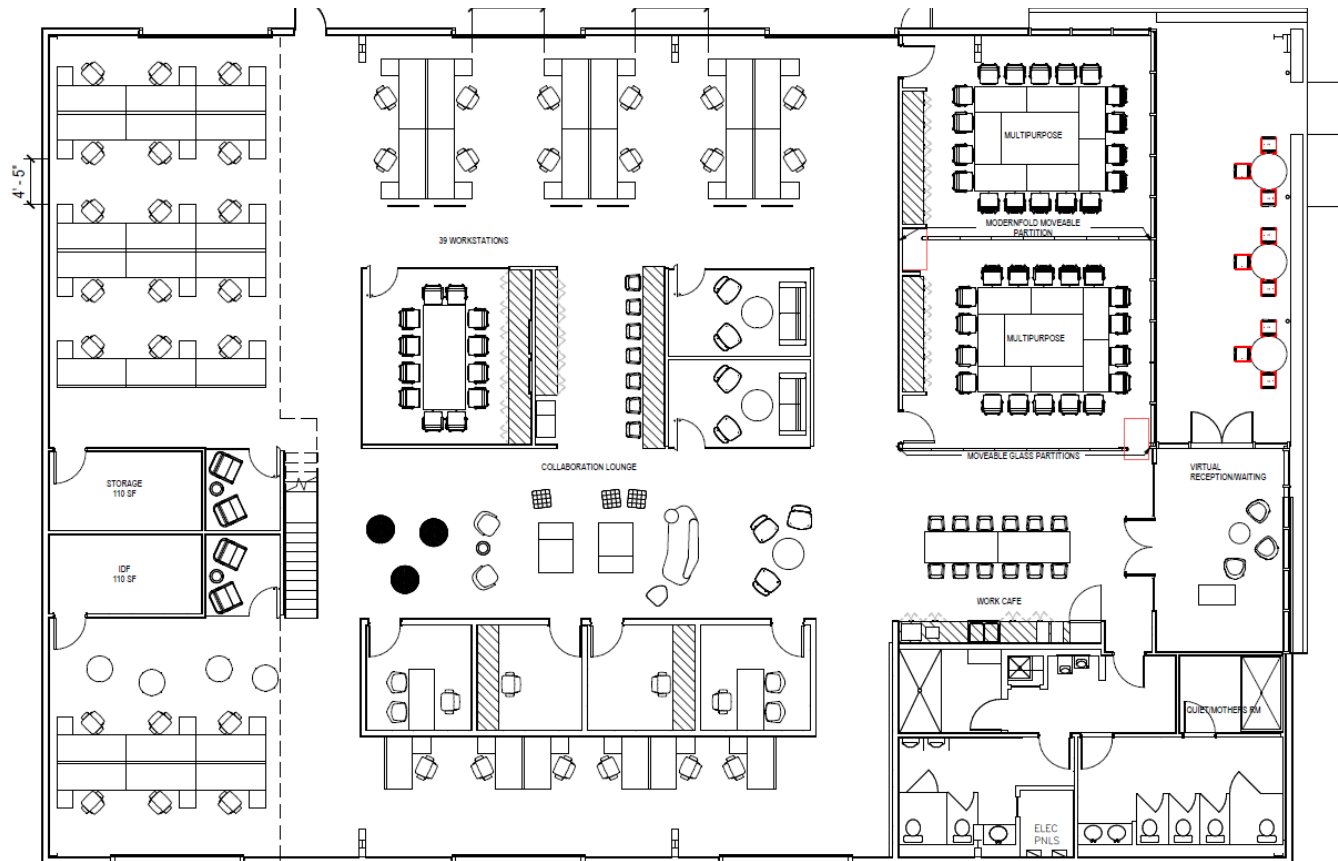

First Floor

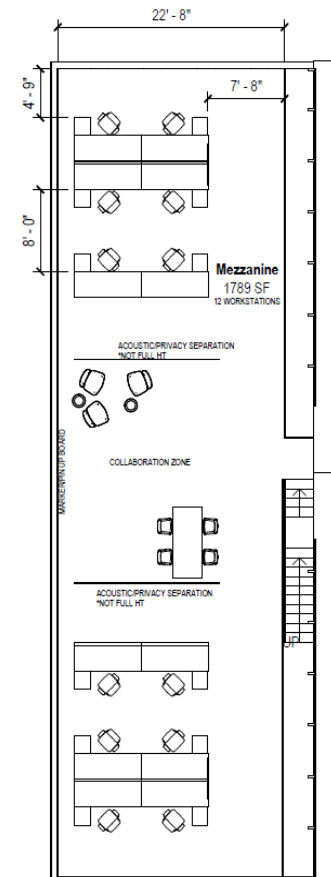

Mezzanine



AREA MAP

2803 MANOR RD.

- 1 Love Supreme
- 2 Fleet Coffee
- 3 Bird Bird Biscuit
- 4 Dai Due
- 5 Haymaker
- 6 El Chilito
- 7 Thunderbird Coffee
- 8 Nixta Taqueria
- 9 Civil Goat
- 10 La Santa Barbacha

 12 minutes to Austin Airport

 8 minutes to Downtown Austin

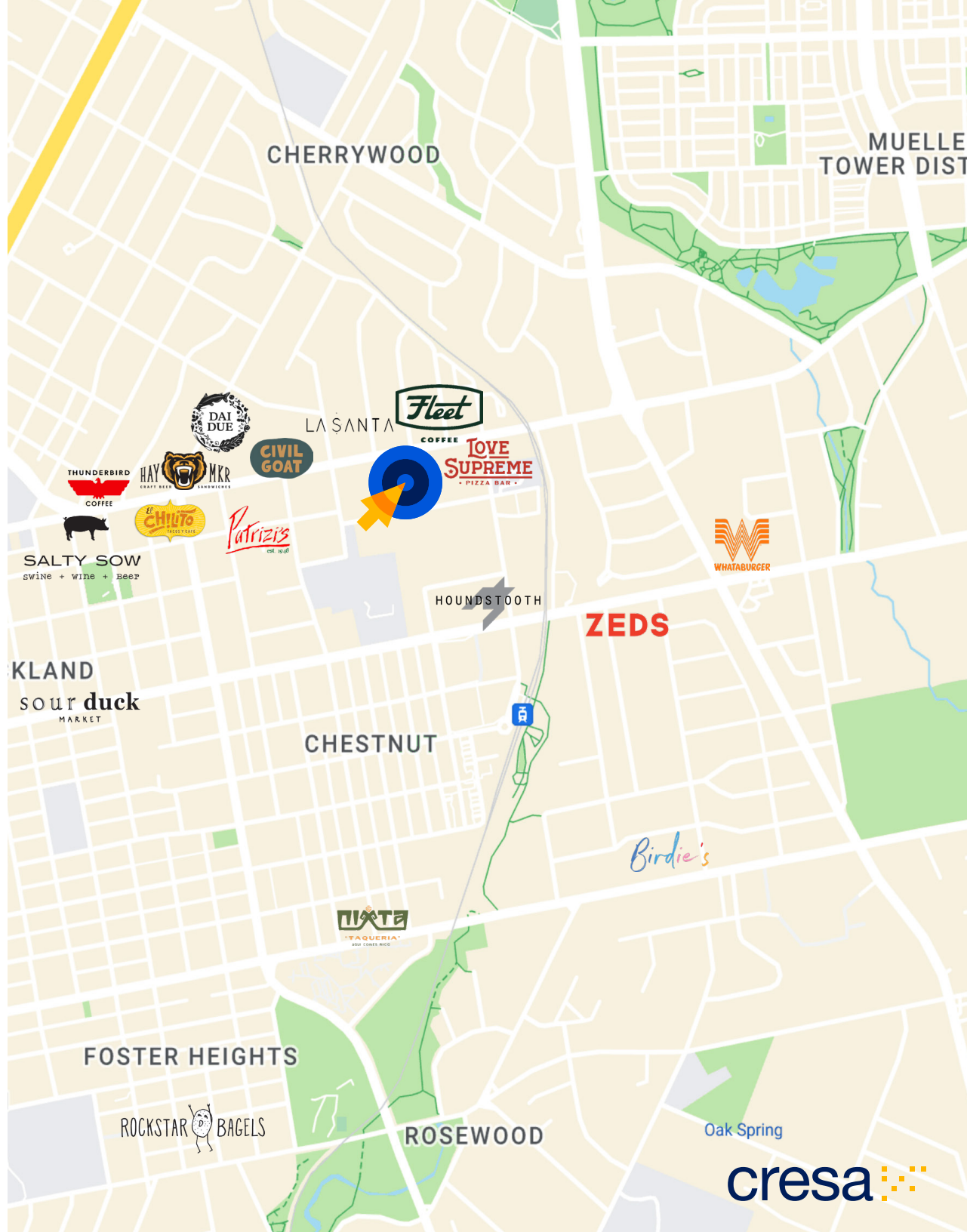



cresa

Contact Broker

Logan Dalglish
ldalglish@cresa.com
913.707.9194

Scott Studzinski
sstudzinski@cresa.com
512.983.7916

Address

901 W. 9th Street
Suite 111
Austin, TX 78703

[TREC Information on Broker Services](#)

Even though obtained from sources deemed reliable, no warranty or representation, express or implied, is made as to the accuracy of the information herein, and it is subject to errors, omissions, change of price, rental or other conditions, withdrawal without notice, and to any special listing conditions imposed by our principals.