

Sublease Available

1818 Market Street
Philadelphia, PA

Sublease Profile

Floor	Entire 25th
Term	Will consider 3 years up to 3/2032
Building Class	A
Building Renovated	2015
Parking	Negotiable

Suite, Occupancy Dates & Condition

North Suite

6,431 - 16,440 SF
120 Days from Permit
Raw Space

Space Details

North Suite: 6,431 - 16,440 RSF

- Currently raw space
- Tenant Improvement Allowance Available
- Conceptual test-fits shown below (construction pricing available upon request)

Building Amenities

- Tenant-only gym with showers and lockers; conferencing facility (10-seat) & training facility (36-seat)
- Saxby's Coffee & Marathon Grill
- 24/7 Security

For More Information



Eric Pinchak
610.684.1993
epinchak@cresa.com



Jeff Baker
610.825.2292
jbaker@cresa.com

Even though obtained from sources deemed reliable, no warranty or representation, express or implied, is made as to the accuracy of the information herein, and it is subject to errors, omissions, change of price, rental or other conditions, withdrawal without notice, and to any special listing conditions imposed by our principals.

1 Fayette Street, Suite 100, Conshohocken, PA 19428



Market St

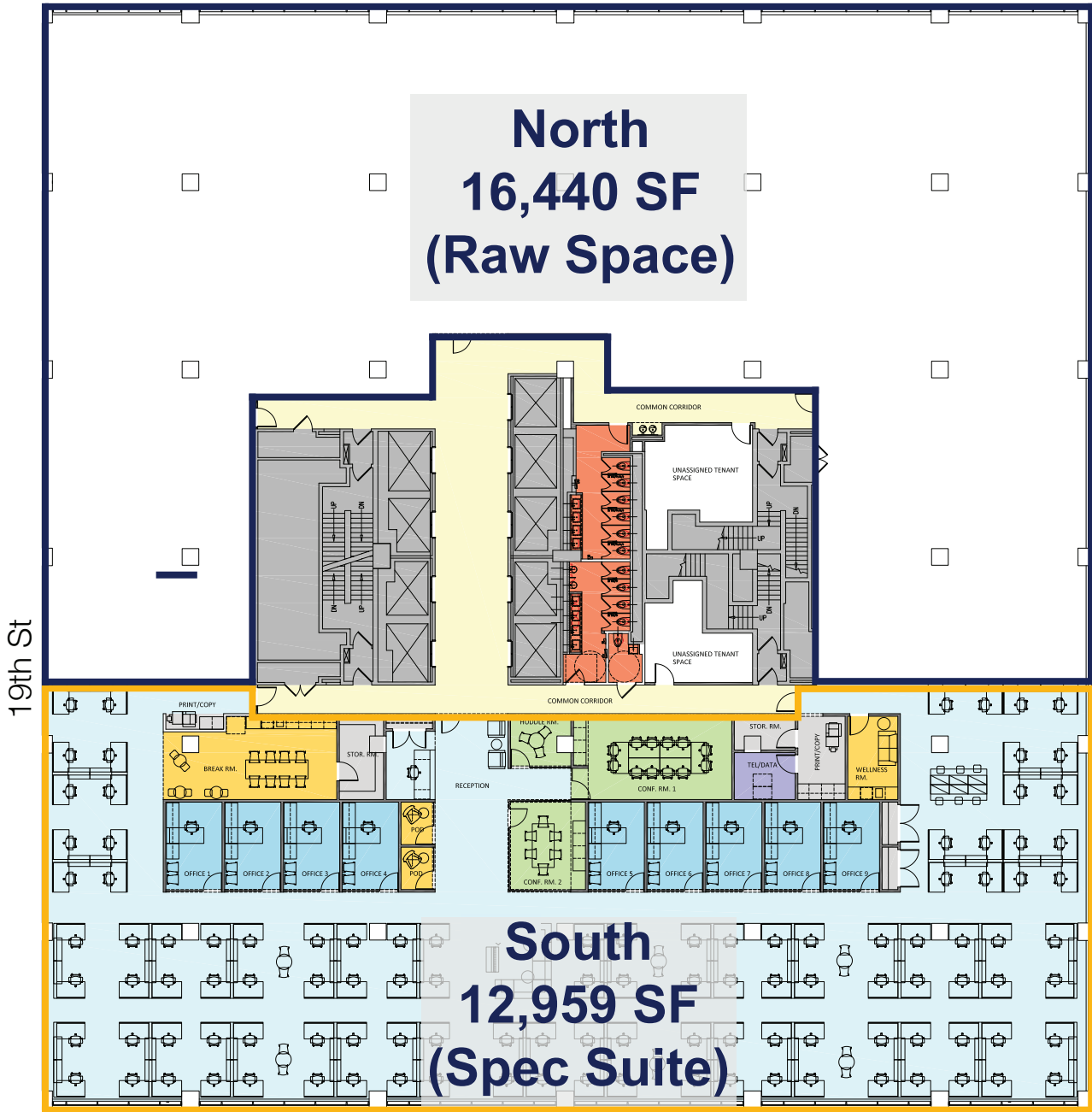

For More Information

Jeff Baker
610.825.2292
jbaker@cresa.com

Eric Pinchak
610.684.1993
epinchak@cresa.com

Area Types

- CIRCULATION
- COMMON / AMENITY
- OPEN OFFICE
- CLOSED OFFICE
- CONFERENCE
- SUPPORT / UTILITY / STOR.
- IT
- BASE BLDG. RESTROOM

Market St

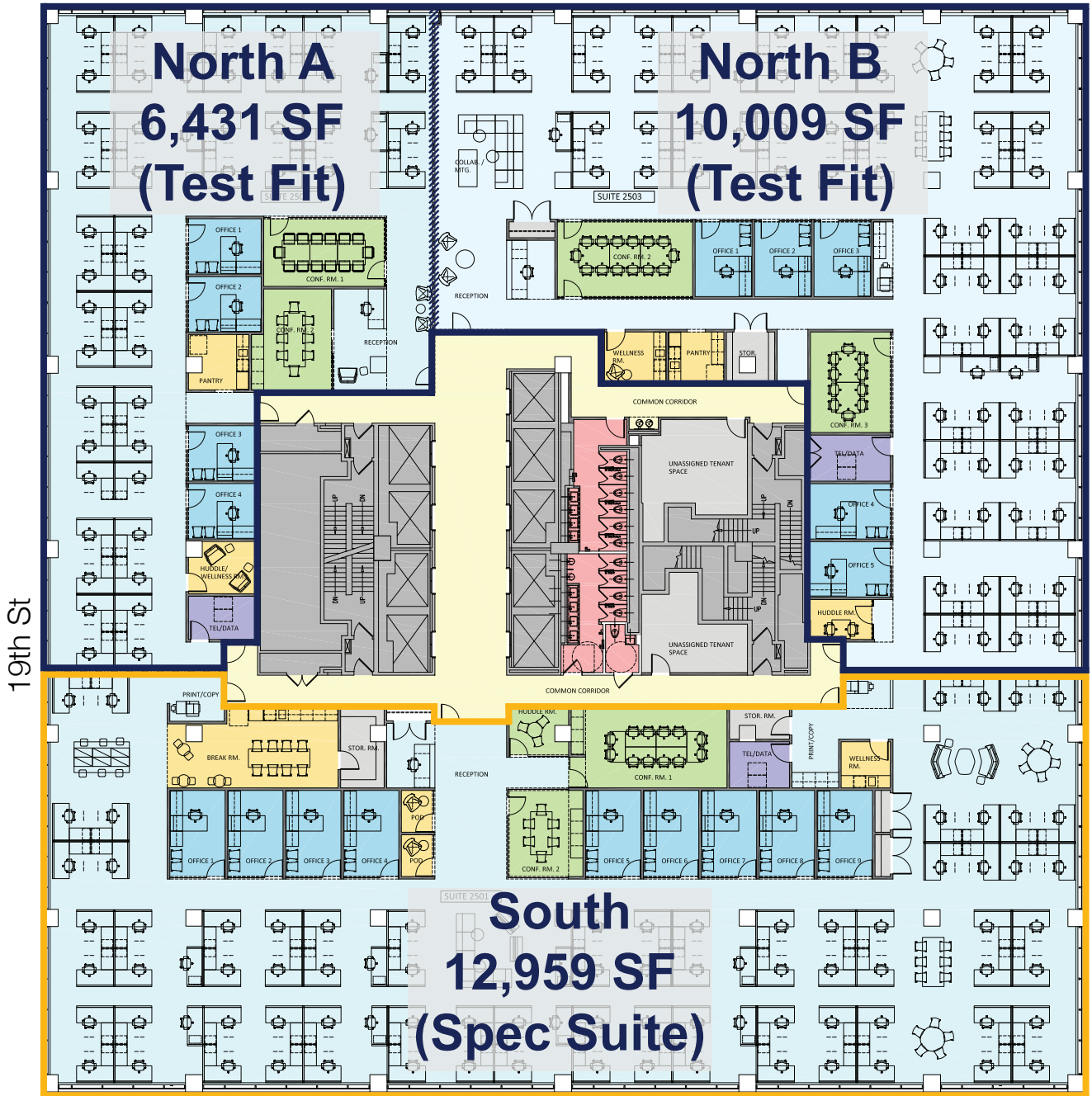

For More Information

Jeff Baker
610.825.2292
jbaker@cresa.com

Eric Pinchak
610.684.1993
epinchak@cresa.com

Area Types

- CIRCULATION
- COMMON / AMENITY
- OPEN OFFICE
- CLOSED OFFICE
- CONFERENCE
- SUPPORT / UTILITY / STOR.
- IT
- BASE BLDG. RESTROOM