

cresa  ROYAL LEPAGE
COMMERCIAL

SUB-SUBLEASE

#104A – 1829 Beaufort Ave
Comox, BC V9M 1R9



**Nicely improved office space ideally
located on Comox's waterfront.**

cresa  ROYAL LEPAGE
COMMERCIAL

SUB-SUBLEASE

#104A - 1829 Beaufort Ave
Comox, BC V9M 1R9

Details

Size: 1,650 SF

Net Rent: Contact Agents

Addtl. Rent: \$9.50 (2023)

Available: Immediately

Expiry: 03/30/2026

Furniture: Available

Parking: 3x dedicated stalls



Nicely improved & bright office space



Multiple cafes & restaurants nearby



8 min drive to downtown Courtenay



Floor Plan

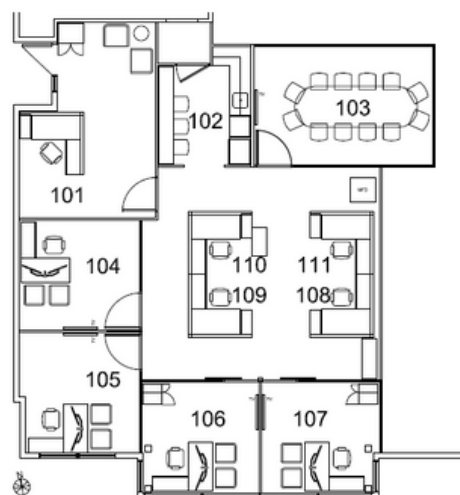

Get in Touch

Sue McKitrick
+1 250 650 8823
suemckitrick@royallepage.ca

Ella Mosky
+1 604 628 0265
emosky@cresa.com
cresa 

ROYAL LEPAGE
COMMERCIAL

cresa

ROYAL LEPAGE
COMMERCIAL

SUB-SUBLEASE

#104A – 1829 Beaufort Ave
Comox, BC V9M 1R9

About

Opportunity to Sub-Sublease 1,650 SF of modern office space in Comox's Harbour Centre professional building. Harbour Centre is comprised of 20,000 SF of commercial space across two storeys.

Suite 104A is improved with 4 private offices, 1 large boardroom, a generous reception/ waiting area, a kitchenette and, an open work space. Nearby amenities include; restaurants, various professional services, banks and, medical services all just steps away from Comox's charming Marina Park and Harbour Front Walk Way.



Get in Touch

Sue McKitrick
+1 250 650 8823
suemckitrick@royallepage.ca

Ella Mosky
+1 604 628 0265
emosky@cresa.com
cresa

Location

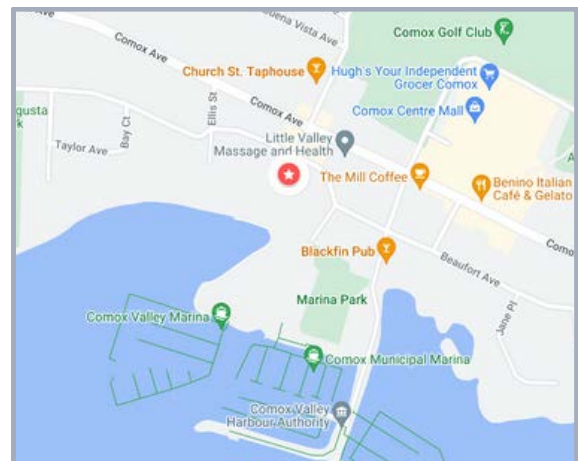

cresa   ROYAL LePAGE
COMMERCIAL

SUB-SUBLEASE

#104A – 1829 Beaufort Ave
Comox, BC V9M 1R9

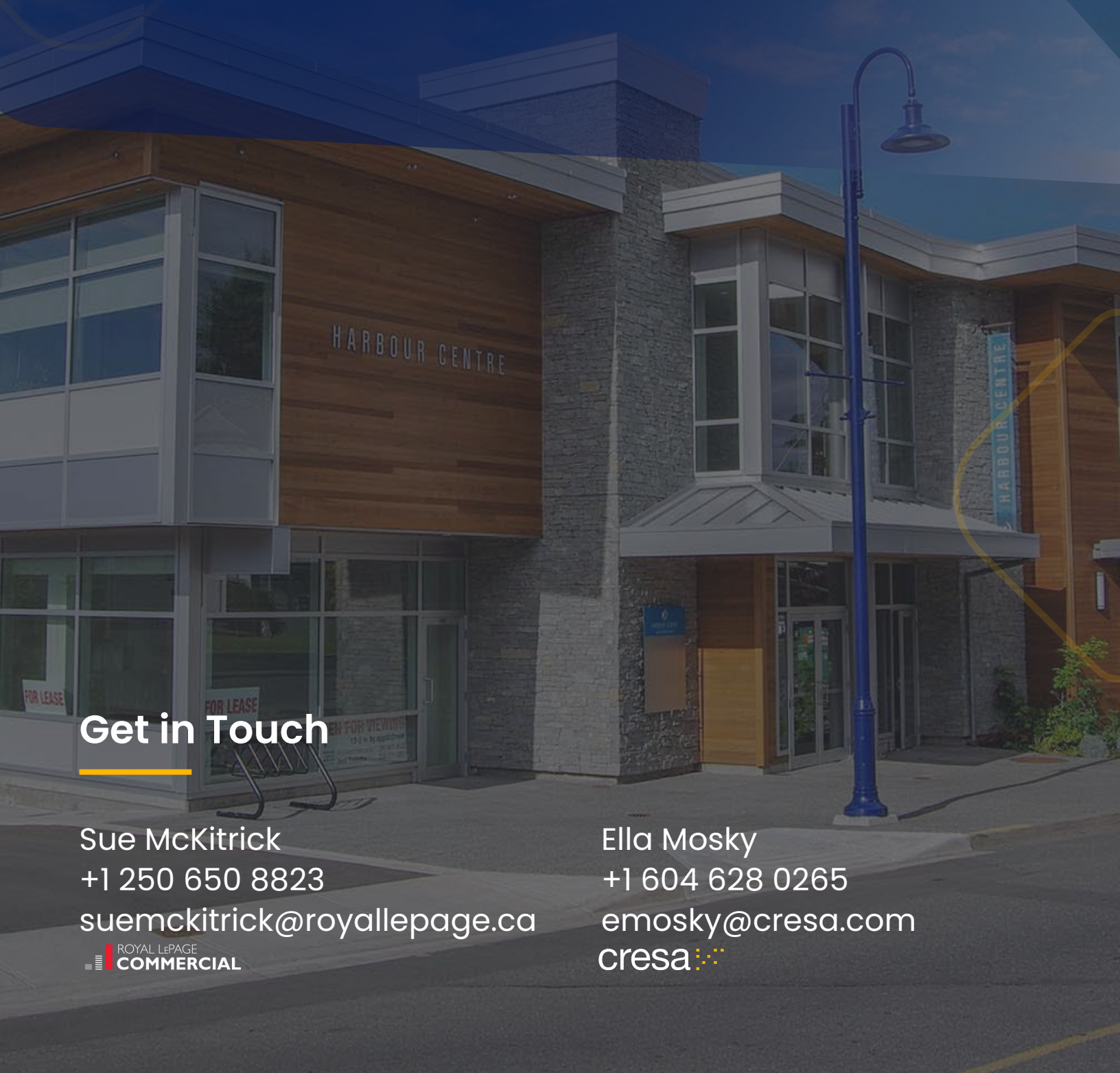

Get in Touch

Sue McKitrick
+1 250 650 8823
suemckitrick@royallepage.ca

 ROYAL LePAGE
COMMERCIAL

Ella Mosky
+1 604 628 0265
emosky@cresa.com
cresa 